



WESTGARTH TYPE H

1326 CROWE WAY, ROCKBANK

FIXED PRICE

\$584,950*

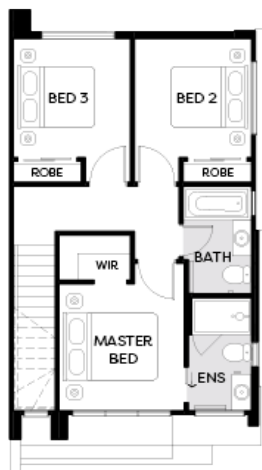
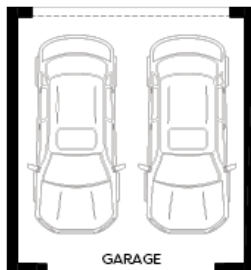

 **3**
 **2**
 **2**

Land Size 239m²

Home Size 17SQ

- Architectural façade
- 2590mm Ceiling heights to ground floor
- 20mm Stone benchtops including waterfalls (*Design specific*)
- 20mm stone benchtop to ensuite and bathroom
- Fisher & Paykel Kitchen appliances including dishwasher
- Mirrored splashback to kitchen
- Coloured concrete driveway and front path
- Flooring timber laminate and carpet
- Tiled shower bases
- Colorbond sectional garage door with dual remotes
- Landscaping to front and rear including letterbox, clothesline and fencing