



Artist Impression.

## REGENT | LOT 5 | ROSELLE

LOT 5 SPRINGVALE ROAD, ROSELLE, SPRINGVALE SOUTH

FIXED PRICE

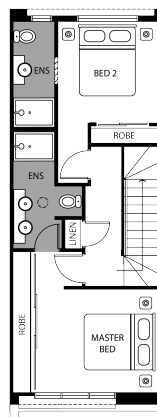
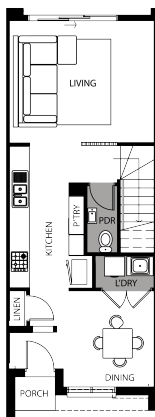
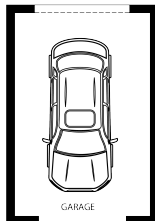
**\$764,950\***

Land Size	140m <sup>2</sup>
-----------	-------------------

Home Size	14SQ
-----------	------

- Architectural façade
- 2590mm Ceiling heights to ground floor
- 20mm Stone benchtops including waterfalls (*Design specific*)
- 20mm stone benchtop to ensuite and bathroom
- Fisher & Paykel Kitchen appliances including dishwasher
- Mirrored splashback to kitchen
- Coloured concrete driveway and front path
- Flooring timber laminate and carpet
- Tiled shower bases
- Colorbond sectional garage door with duel remotes
- Landscaping to front and rear including letterbox, clothesline and fencing